

[ USA ]



**PLEASE - BEFORE RETURNING TO STORE:**  
**Contact Huffy Customer Service.**  
We are glad to assist you  
with any parts or assembly problems you might have!

For Fast Customer Service and email:

[www.huffybikes.com/contact](http://www.huffybikes.com/contact)

OR TEL: 1 800 872 2453 (US)

To Order Parts:

[www.huffybikes.com/parts](http://www.huffybikes.com/parts)

[ CANADA ]

**PLEASE - BEFORE RETURNING TO STORE:**  
**Contact Huffy Customer Service.**

We are glad to assist you with any parts or assembly problems you might have!

**AVANT DE RETOURNER AU MAGASIN :**

**Communiquiez avec le service à la clientèle de Huffy. Nous vous aiderons  
volontiers avec tout problème concernant les pièces ou le montage!**

For fast customer service in Canada / Pour un service à la clientèle rapide au Canada :

Call / Appelez : 1-800-872-2453

Or Email / Ou Courriel : [huffycanada@huffy.com](mailto:huffycanada@huffy.com)

Or visit / Ou visitez : [www.huffybikes.com/global-contacts](http://www.huffybikes.com/global-contacts)

[ MÉXICO ]

**ANTES DE DEVOLVER EL PRODUCTO A LA TIENDA:**

**Comuníquese Con Servicio Al Cliente De Huffy. Nos Complace Ayudarlo Con  
Cualquier Parte O Problema De Ensamblado Que Pudiera Tener.**

Para obtener Servicio al cliente rápido, visite:

[www.huffybikes.com.mx](http://www.huffybikes.com.mx)

Contáctanos por WhatsApp al 222 422 4955

Visita nuestra página de Facebook HuffyMexico

● LLAME AL TEL:

800 1 HUFFY 1 (800 1 48339 1)

(Mexico only)

Para comunicarse por correo electrónico:

[servicio.mexico@huffy.com](mailto:servicio.mexico@huffy.com)



For ASSEMBLY Help:  
Aide à l'ASSEMBLAGE :  
Ayuda de la ASAMBLEA:

<https://www.huffybikes.com/global-contacts/>



for current contact information /  
pour les informations de contact  
actuelles / para obtener la  
información de contacto actual

Please REGISTER your Product:  
Veuillez ENREGISTRER l'article :  
Por favor, REGISTRE su producto:



H-InlineScooter LED 11-22-21 m0944 4C



Date Code Label  
Here



**In-Line LED Scooters**  
(100 - 145 mm) Owner's Manual

\* Styles and  
Accessories  
may vary



**This manual contains important safety, assembly, operation  
and maintenance information.**

**Please read and fully understand this manual before  
operation.**

Save this manual for future reference.



Always wear approved helmet and safety equipment when  
using this product.

**See back page for Customer Service Information**

# Index

## ENGLISH

• Parts Assembly.....	3
• Safety Information.....	4-5
• Assembly.....	6-10
• Operation.....	11-12
• Maintenance.....	13
• Warranty - Australia.....	14
• Warranty - US.....	15

### Back Cover:

- Return and Service Contact information
- Registration QR Code Link
- Assembly QR Code Link

## ! WARNINGS

- The user must be **5+ years**, and weigh no more than **220 lb (100 kg)**.
- Avoid sharp bumps, drainage grates, and sudden surface changes. Scooter may suddenly stop. Watch out for pedestrians.
- Check and secure all fasteners before every ride.
- Avoid excessive speed associated with downhill rides.

## ! WARNING:

Dispose of used batteries immediately. Keep new and used batteries away from children. If you think batteries might have been swallowed or placed inside any part of the body, seek immediate medical attention.

## ALWAYS WEAR YOUR HELMET WHEN RIDING THIS PRODUCT!

Always read the user manual that comes with your helmet to make sure it is fitted and attached properly to the wearer's head according to the fitting instructions described in the user manual.

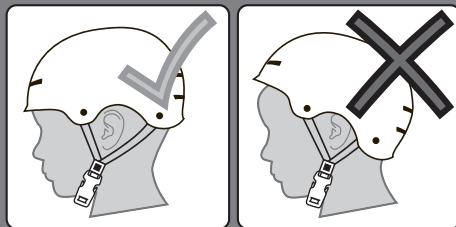

This Class A scooter complies with EN14619:2019

## Limited Warranty - US

### General:

Part or model specifications are subject to change without notice.

This Limited Warranty is the only warranty for the product. ALL WARRANTIES OTHER THAN STATED HEREIN ARE DISCLAIMED INCLUDING IMPLIED WARRANTIES OF MERCHANTABILITY AND FITNESS FOR A PARTICULAR PURPOSE, TO THE EXTENT ALLOWABLE BY APPLICABLE LAW. ALL LIABILITY FOR INCIDENTAL, PUNITIVE, SPECIAL, OR CONSEQUENTIAL DAMAGES ARE EXPRESSLY DISCLAIMED, TO THE EXTENT ALLOWABLE BY APPLICABLE LAW.

The only uses for this product are described in this manual.

Warranty registration is not required.

The Limited Warranty extends only to the original consumer and is not transferable to anyone else.

### What does this Limited Warranty cover?

This Limited Warranty covers defects in workmanship and materials for all parts of the product except those indicated below as not warranted.

### What must you do to keep the Limited Warranty in effect?

*This Limited Warranty is effective only if:*

- Product is completely and correctly assembled.
- Product is used under normal conditions for its intended purpose (see the following section for excluded activities).
- Product receives all necessary maintenance and adjustments.
- Product is used for general transportation and recreational use only.

### What is not covered by this Limited Warranty?

This product is designed for recreational use only. This Limited Warranty does not cover normal wear and tear, normal maintenance items, or any damage, failure, or loss that is caused by improper assembly, maintenance, adjustment, storage, or use of the product. This Limited Warranty does not extend to future performance.

### This Limited Warranty will be void if the product is ever:

- Used in any competitive sport
- Used for stunt riding, jumping, aerobatics or similar activity
- Modified in any way

- Modified with the addition of a motor
- Ridden by more than one person at a time
- Rented, sold, or given away
- Used in a manner contrary to the instructions and warnings in this Owner's Manual

### What will The Manufacturer do?

Manufacturer's sole and exclusive obligation under this Limited Warranty is to repair and/or replace, at its sole option, any covered defect in workmanship or materials.

### How do you get service?

Contact the Customer Service Department.

- See included list for Customer Contact information.

### What rights do you have?

This Limited Warranty gives you specific legal rights. You may also have other rights which vary from state to state, region to region.

### For how long does this Limited Warranty last?

- When used in this Limited Warranty, the phrase "for life" means for as long as the original consumer owns the product.
- All components are warranted for 6 months from the date of purchase. Electronics and Wheels: 90 days.



#	Description	#	Description
1	Handlebar T-Handle w/hardware	7	Front Wheel/hardware
2	Lock Collar	8	Stem LED light tube
3	LED Grip End assembly (x3 LR41 (AG3)	9	Fork Assembly w/hardware
4	Battery door/Battery (3xAAA)	10	Bushing
5	Rear Fender/Brake	11	Steer Tube Assembly
6	Rear Wheel/hardware	12	Allen Wrench

## Safety and Warning Information

This product, like all wheeled vehicles, will provide safe, enjoyable transportation and recreation when used and maintained properly. Like bicycling, skateboarding, and in-line skating, riding this product can be dangerous even under the best of circumstances. We do not want you to get hurt. Please follow these safety rules. After assembly, dispose of packaging according to local practice and requirements.



This symbol is important. It is the **WARNING** symbol. The warning symbol precedes safety instructions. Make sure the child understands these instructions. Failure to follow these instructions may result in injury to the rider or to others, or damage to the product.



### WARNING TO AVOID SERIOUS INJURY:

- Adult assembly required.
- CHOKING HAZARD: Small parts. Not for children under 3 years.
- Keep small loose parts and plastic bags out of the reach of children.
- Not suitable for children under 3 years as foam pieces may break off and pose a choking hazard.
- As required, adults must assist children in the initial adjustment procedures to unfold the scooter, adjust handlebar and steering to height, and finally to fold the scooter.
- Continuous adult supervision required.
- Never ride with more than 1 person.
- Excessive weight may cause a hazardous or unstable condition.
- Never use near motor vehicles.
- Do not modify the product.
- **Protective Equipment must be worn:** Always wear safety equipment such as helmet, knee pads, elbow pads, wrist guards and gloves.
- Always wear shoes when using this product.
- While using the product, keep hands and fingers away from wheels and other moving parts to avoid danger of pinching or entrapment.
- Always wear a properly fitted AS/NZS (Australia) CPSC (US) approved helmet when riding the scooter and keep the chinstrap securely fastened.
- Ride on smooth paved surfaces away from motor vehicles. Not for use on roads or in traffic.
- Do not allow a child to ride on roadways or alleys.
- Do not allow a child to ride off road, on grass or wet surfaces.
- Never use near streets, swimming pools (or other bodies of water), hills, steps, or sloped driveways.
- Avoid sharp bumps, drainage grates, and sudden surface changes. Scooter may suddenly stop.
- Avoid streets and surfaces with water, sand, gravel, dirt, leaves, and other debris. Wet weather impairs traction, braking and visibility.
- Do not allow a child to ride the product at dusk, at night or at times of limited visibility.
- Understand all operating procedures before use.
- Do not tow or pull any objects with the product.

## Maintenance

The scooter should be checked periodically for any loose, broken, or worn parts. Tighten any parts that are loose, and replace any worn or broken parts immediately. Periodic cleaning will prolong the useful life of this scooter.

### SELF-LOCKING FASTENERS:

With repeated use, Self-Locking Fasteners may lose their ability to lock to the threads and may come loose. Frequently check Self-Locking Fasteners and replace when worn.

### INSPECTION OF THE BEARINGS:

Frequently check the wheel bearings of the product. Replace the wheels when the bearings do not pass the following tests:

Lift each end of the product off the ground and spin the raised wheel by hand:

- The wheel should spin freely and easily.
- There should be no side-to-side movement at the wheel edge when pushed to the side with light force.

### WEEKLY SERVICE:

Apply a few drops of general purpose oil to the sides of each wheel axle. Verify that the axle fasteners are tight.



### ACCESSORY BATTERY WARNINGS:

- Do not mix old and new batteries.
- Do not mix alkaline, standard (Carbon-Zinc) or rechargeable batteries.
- Battery replacement is to be conducted by an adult.
- Dispose of batteries properly. Do not dispose of batteries in fire, batteries may explode or leak. Check local regulations for proper battery disposal.
- Non-rechargeable batteries are not to be recharged.
- Different types of batteries or new and used batteries are not to be mixed.
- Only batteries of the same or equivalent type as recommended are to be used.
- Batteries are to be inserted with the correct polarity.
- Keep the unit from getting wet.
- The battery supply terminals are not to be short-circuited.
- Rechargeable batteries are to be removed from the unit before being charged.
- Rechargeable batteries are only to be charged by adults.
- When installing new batteries, look for dangers such as damage, heat, liquid leakage etc.
- Remove batteries when product is not used for long periods of time.
- Exhausted batteries are to be removed from the product.

## Operating and Braking

**RIDING:** The scooter is operated by placing one foot on the deck and pushing with the other foot.

**BRAKING:** On some models the rear fender is hinged for use as a brake. With heel of foot, push down on rear fender to slow and stop scooter. Allow extra braking distance in wet weather. **Fender will be hot after braking.**

**STEERING:** While moving forward, gently turn handlebar and lean slightly into turn.

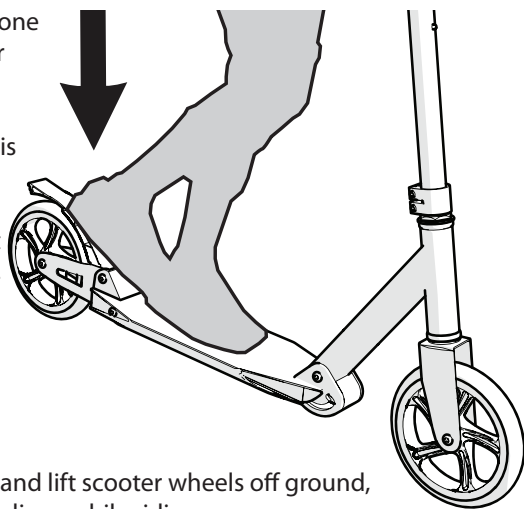

### WARNINGS:

- Scooters with wide decks may hit ground and lift scooter wheels off ground, causing an accident. Be careful of surroundings while riding.
- Always wear shoes when riding the scooter.

## Safety and Warning Information - continued

- Do not push or pull a child riding on the product.
- Use with caution, since skill is required to avoid falls or collisions causing injury to the user or third parties.
- Brake will get hot from continuous use. Do not touch after braking.
- Avoid excessive speed associated with downhill rides. It may be difficult to stop or maneuver quickly. Maximum recommended speed is 6 MPH (10 KPH).
- Obey all local traffic and scooter riding laws and regulations.
- Watch out for pedestrians.
- Do not wear headphones or anything else that would impair your ability to hear or see.
- Practice riding in large, flat areas.
- Avoid steeply sloped areas. Get off and walk.
- Know your limits. Be familiar with your scooter and your abilities. Use common sense.
- Handlebar hand grip or tube end-plugs should be replaced if damaged as bare tubes have been known to cause injury. All products with capped handlebar ends should be checked regularly to ensure that adequate protection for the ends of the handlebars are in place.
- Ensure all locking devices are engaged before each ride.
- Check and secure all fasteners before every ride.
- If anything does not operate properly, discontinue use.
- Replace worn or broken parts immediately with original equipment.
- Before each ride, check that the steering system is correctly adjusted and that all connection components are firmly secured and not broken.
- Always comply with local laws and regulations.

### **Additional Safety Warnings:**

- It is the responsibility of the adult to educate the child and determine if they are capable of operating the vehicle safely.
- Before using the vehicle the child must understand the controls and safety issues. They must also demonstrate the capability and skill to handle the vehicle and operate its controls to avoid falls or collisions.
- After complete assembly, remove and dispose of all protective material and poly bags. Keep poly bags away from child. Be sure to remove all packaging materials and parts from underneath the vehicle body.
- Ensure child uses common sense and safe practices when using the vehicle.
- An adult must unfold and fold this product (as equipped).
- At the end of useful product life, dispose according to local practice and requirements.

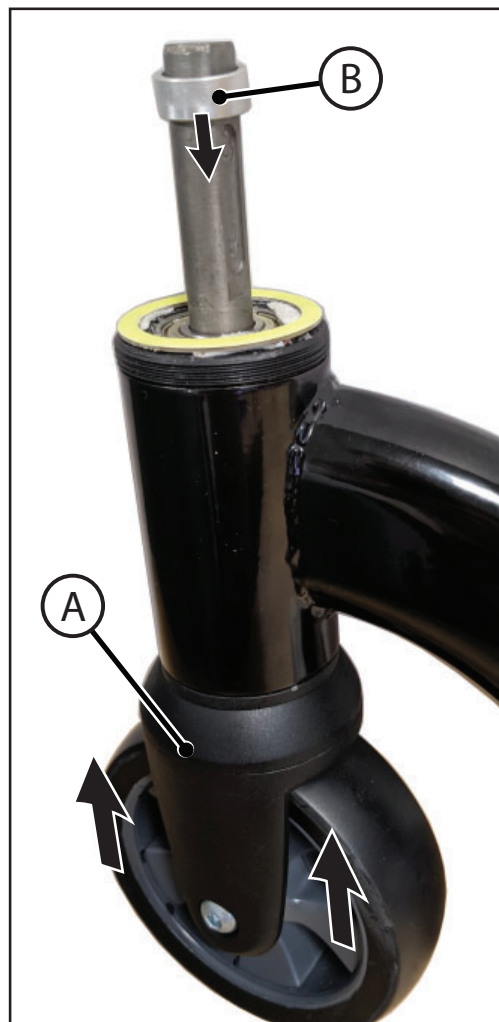

## Assembly

**STEP 1:**

1. Insert Fork Assembly (A) UP into frame as shown.
2. Place Spacer (B) down onto Fork Shaft as shown.

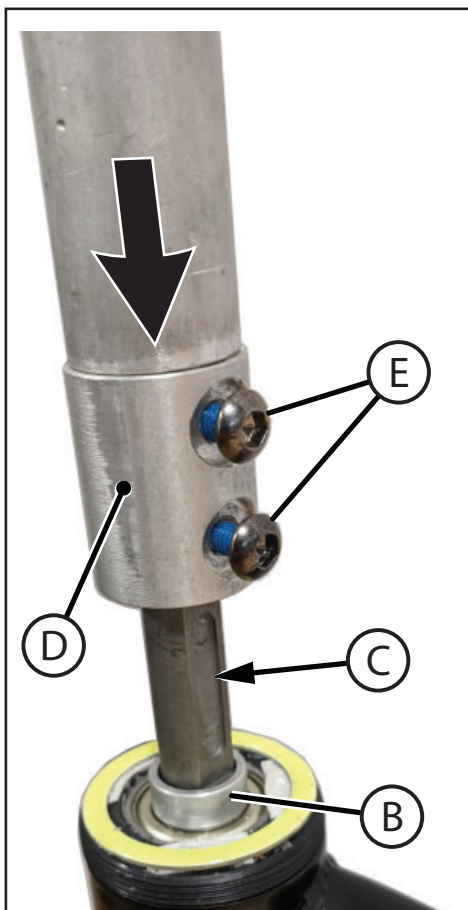
**STEP 2:**

(set scooter on ground with weight on front wheel)

1. With Fork Screw Slot (C) facing BACK, slide Steering Support (D) down on shaft and against Spacer (B).
2. Tighten two Allen Screws (E) fully and securely.

## LED Deck and Batteries

**Battery Replacement (Turn front wheel to the side as shown):**

1. Loosen the battery compartment cover Screws and remove the Cover (A).
2. Insert/Replace Batteries (3 - AAA) (B) in the same position and orientation as originals.
3. Re-install the compartment cover and tighten the screw.

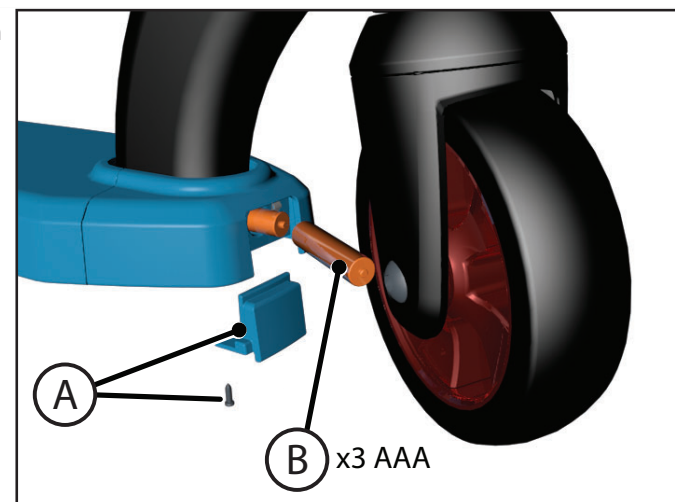
**NOTES:**

- LED Lights (if equipped) on wheels, Deck or Stem light up through vibration while riding.

**Battery Replacement - Handlebar End Caps:**

1. Remove grip End Cap (A) with screwdriver.
2. Unscrew the end cap Battery Holder (B) with screwdriver.
3. Remove Light/Battery fixture (C) and remove Battery Sleeve (D) and Batteries (E).
4. Replace 3 Button Cell Batteries with **3 new LR41 (AG3)** Batteries in same orientation as originals.
5. Re-install in reverse order and push in grip End Cap (A) fully.

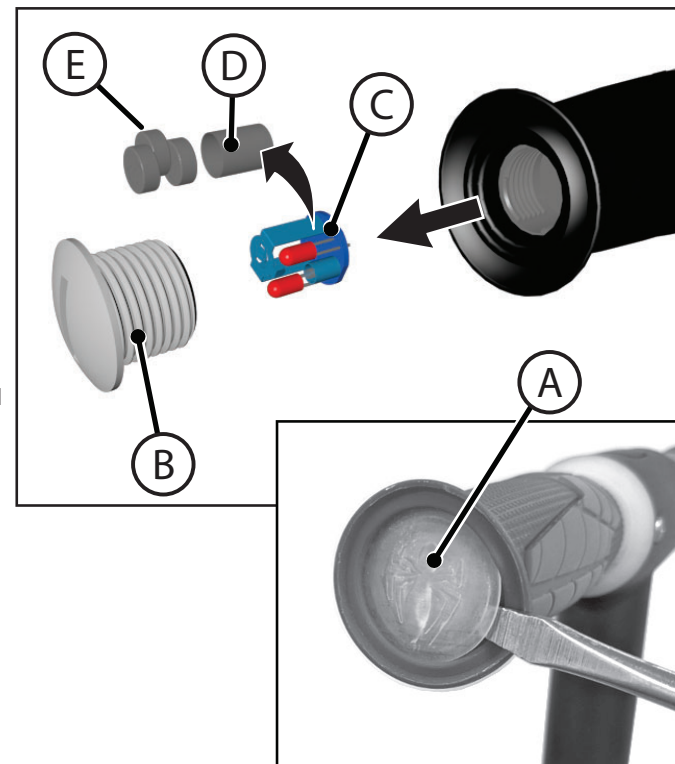

## Assembly

**MODELS WITH UNASSEMBLED FRONT WHEEL:**

1. Remove Shoulder Screws (A) if pre-installed.
2. Place Front Wheel (B) into Fork so that axle holes line up.
3. Install Shoulder Screws (A) fully and securely.

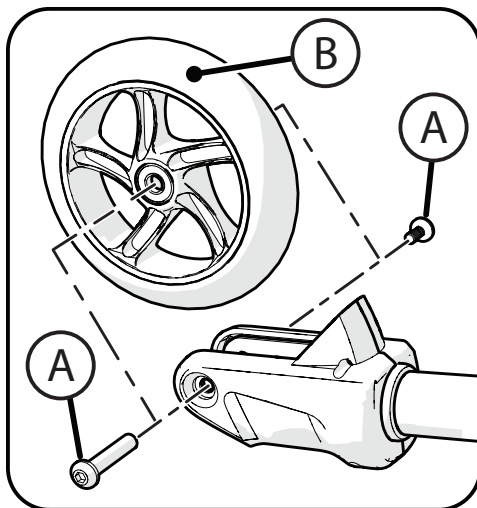
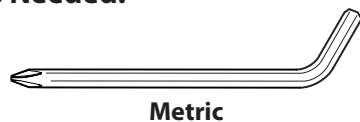
**Tools Needed:**

## Accessories (various models)

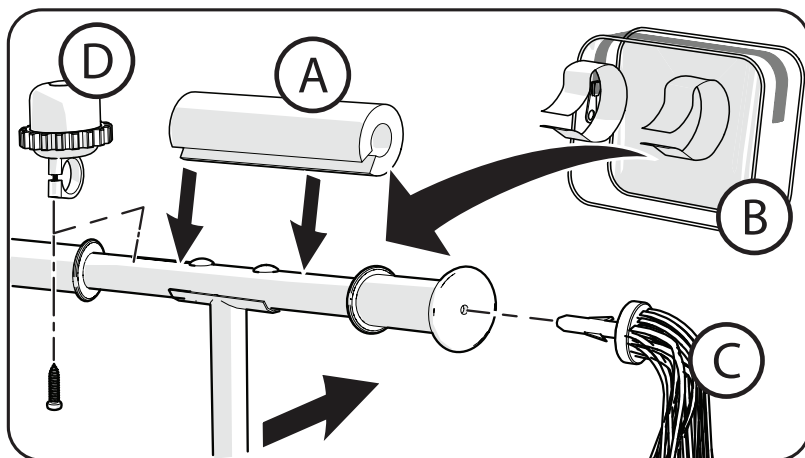

- Attach Handlebar Pad (A) (if equipped) to Handlebar by opening and placing straight down over handlebar and using Hook & Loop Straps to secure. Fasten securely.
- Attached Handlebar Bag (B) (if equipped) by securing bag straps around Handlebar/Pad. Fasten securely.
- Insert both Streamers (C) (if equipped) into ends of grips as shown, fully and securely.
- Position Bell (D) (if equipped) for easy reach and attach with supplied screw.



**WARNING:** Bag Weight Limit: 5 lb (2.3 kg)

## Assembly

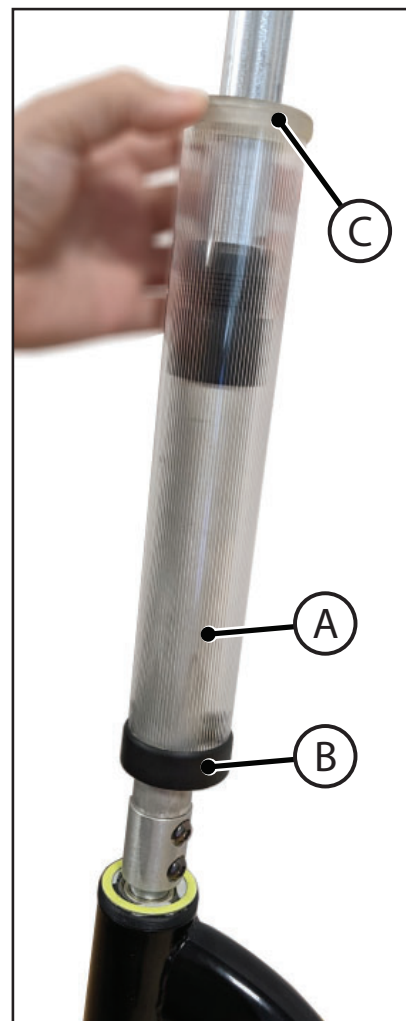
**STEP 3:**

1. Slide Light Tube (A) over Steering Support with Threaded Collar (B) DOWN.
2. Make sure top Collar (C) does not come loose.

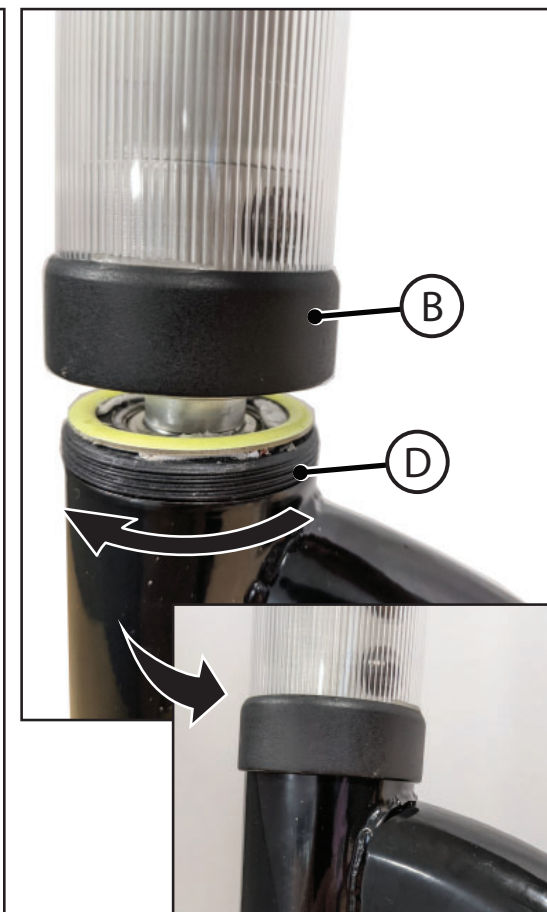
**STEP 4:**

1. Carefully start Threaded Collar (B) onto Threads (D).
2. Fully tighten Collar (B) - **Hand tight only.**

## Assembly

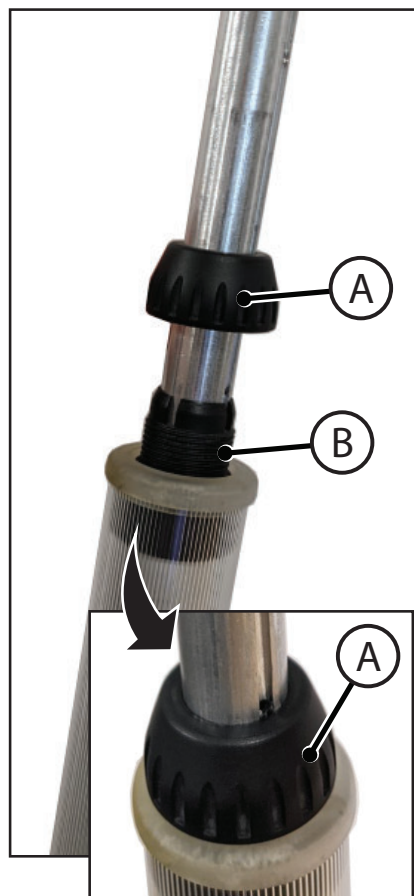
**STEP 5:**

1. Slide Lock Collar (A) down on Steering Support as shown.
2. Tighten Collar (A) onto Thread Support (B) fully and securely - **Hand tight only.**

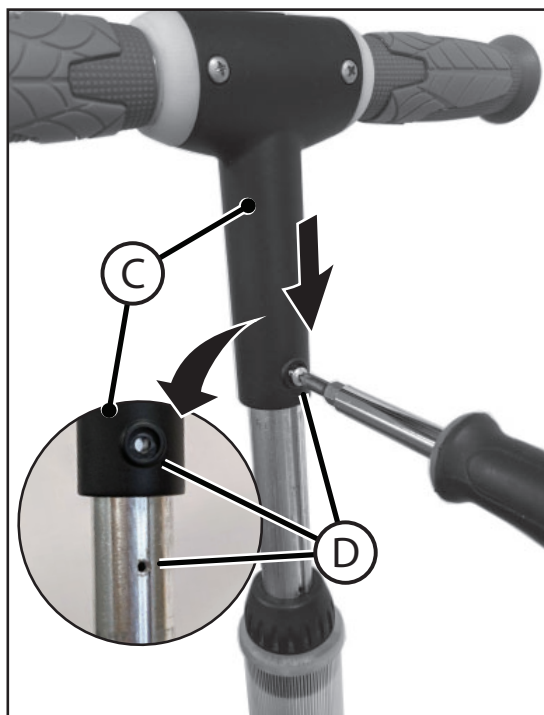
**STEP 6:**

1. With Screw Slot (D) facing BACK, slide Handlebar (C) down onto Support so that mounting screw holes line up (D).
2. Tighten Screw (D) fully and securely.
3. Gently pull up on Handlebar to make sure it does not come loose.

## Assembly

**STEP 7 - ADJUSTING HANDLEBAR HEIGHT:**

Light Tube shown removed for clarity.

1. Begin by loosening Lock Collar (A) several turns.
2. Adjust Handlebar height by pushing down Adjust Button (B) on top of Handlebar.
3. Hold down Adjust Button and move Handlebar up or down so that Lock Pin (C) snaps into correct adjust hole for rider's height.
4. Fully hand-tighten Lock Collar (A).

